



FO800 series 8 channels Fiber Optic slip ring

8 channels Fiber(support single mode/multi-mode) .Suitable for some applications which requires to keep 360° unrestricted,continuous or intermittent rotating and transmit mass data/signal from static side to rotation side, which can improve mechanical performance, simplify system operation and avoiding damages to fiber.

Part No. Description

FO800	- Fiber type -	Connector type-	wavelength
FO800: eight channels Fiber optic rotary joint			Wavelength : 01: 1310/1550 (Single mode) 02: 850/1310 (multi mode)
Fiber type code : 01: 9/125um (Single mode) 02: 50/125um (multi mode) 03: 62.5/125um (multi mode)			Connector type code : FC: FC connector ST: ST connector SC: SC connector LC: LC connector t connector interface is PC by default, if need APC FC/APC pls add APC, as FC/APC

Examples

FO800-01-FC-01: FO800 means 8 Channels Fiber Optic rotary joint, the first 01 means Fiber type 9/125um (single mode), FC means FC connector, fiber interface PC, the second 01 means wavelength : 1310/1550;

FO800-03-LC/APC-02: FO800 means 8 channels Fiber-Electric rotary joint, 03 means Fiber type 62.5/125m (multi-mode), LC/APC means LC connector, APC interface, 02 means wavelength : 850/1310;

*Remark: If you have special requirements for fiber channel no., electric circuit no., Fiber connector type, wavelength or wire exiting, pls contact SenRing salesman.

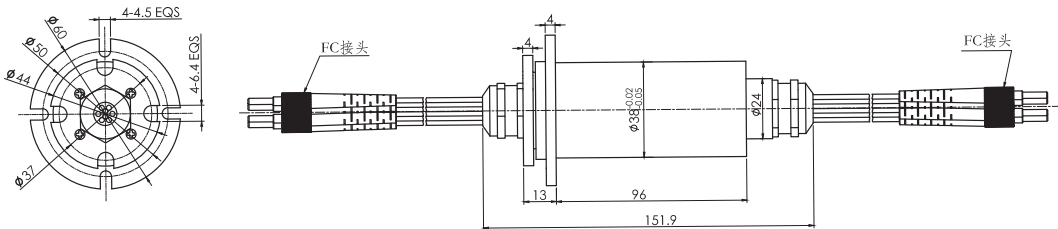

技术规格参数

item	type	Single mode (SM)	multi mode (MM)
Bandwidth(nm)		± 50	
Max insertion Loss, 23°C(dB)		4	3.5
Insertion loss fluctuation(dB)		≤ 2	≤ 1
Return loss(dB)		≥ 50(without connector)	≥ 40(without connector)
max power(W)		0.5	
Max speed(rpm)		400	
Working life		>20 million	
Work Temperature(°C)		-20~60	
Storage temperature(°C)		-50~85	